

# ILLUMINATED WALL MIRRORS



Cantoni has combined the professional quality of the exclusive I-light lighting system (create specifically for make up artists) with large wall mirrors created with essential and simple lines.

The carefully researched distance between the light points, the perfectly neutral colour temperature of 4200 kelvin, the low energy consumption and the total absence of heat emission make them perfect for makeup, professional hairstyling in beauty salons, pharmacies, commercial spaces and makeup schools.

Cantoni's illuminated wall mirrors are divided into two ranges: **MDE and SP**  
Italian handcrafted production.

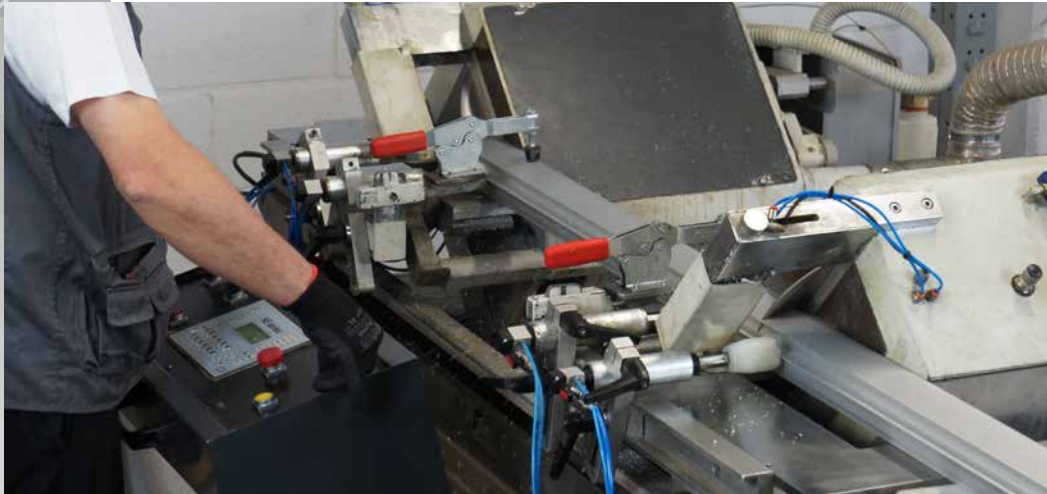

#### ITALIAN PRODUCTION

Advanced machines and *robotic procedures*,  
to ensure **maximum accuracy**



#### ANODISED ALUMINIUM



*I-light brightness adjustable lenses. Stainless steel switch*

Cantoni has combined the unique quality of the exclusive **I-light** system, specific for make-up, with large mirrors and easy to combine to fit any space. The range of MDE mirrors, with linear and essential lines, fits perfectly in any room. Italian artisan production.

- ◆ **Anodized** aluminium structure
- ◆ **Mirror** thickness 4 mm
- ◆ **Power** button with dimmer
- ◆ **6 or 12** I-light
- ◆ **Customizable** surface with company logo or name
- ◆ **Handcrafted in Italy**
- ◆ Safety film
- ◆ 110-240V compatible



#### Technical Details

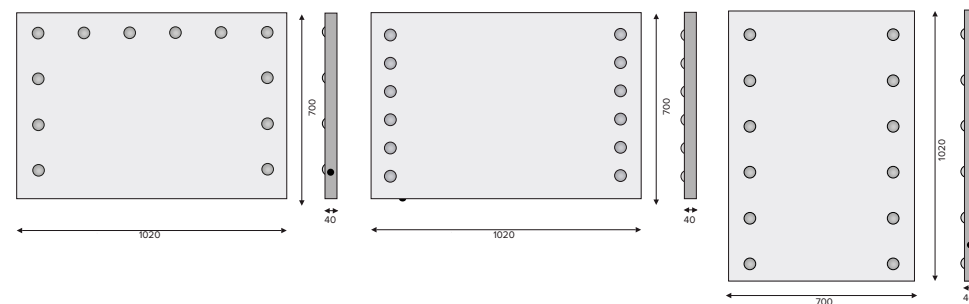

## Wall mirrors MDE line



The electrical output cable of the mirror is not equipped with the plug: it needs to be connected to the electrical wiring of the room.

MDE01 - 1020x700x40 mm  
MDE502 - 1020x700x40 mm  
MDE505 - 700x1020x40 mm



## MDE505 Stand Alone



*l-light brightness adjustable lenses. Stainless steel switch*



*Accessory: satin finished basket with interlocking silver cover*

MDE505 mirror with lights in the stand-alone version: support bar with foot in anodized aluminium. The support bar can be completed on the back side with a **backlit light-box panel** for advertising.

Perfect solution to furnish compact, functional and easy to set up promotional corners. Customizable.

- ◆ Support bar with foot in anodized aluminium
- ◆ **Optional accessories** available: shelves, satin finished basket
- ◆ Completable with backlit light-box panel

### Technical Details

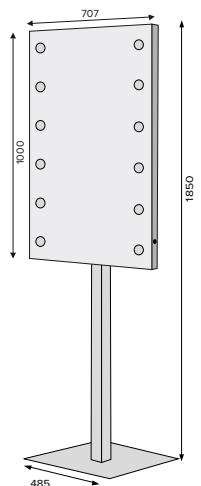

## MDE505 Stand Alone



MDE518.black



*I-light brightness adjustable lenses. Stainless steel switch*



*Support surface in black painted aluminum*

MDE518 mirror with light, black profile, support surface placed in the front of the mirror, removable.

Wall version or version with support bar and foot in black painted aluminum. Perfect solution to furnish compact, functional and easy to set up promotional corners.

- ◆ Mirror thickness 4 mm
- ◆ **12 I-light lamps**
- ◆ **Handcrafted in Italy**
- ◆ Safety film
- ◆ 110-240V compatible

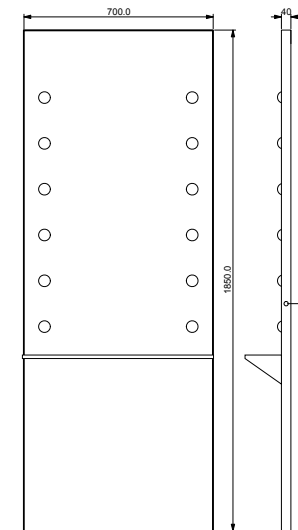

#### Technical Details

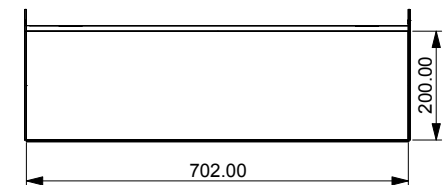

MDE518.black



## MDE518.rolling mirror



*Uprights in silver painted beech,  
4 wheels with brake*



*Power cable outlet in  
back of the mirror*



*I-light brightness adjustable lenses.  
Stainless steel switch*

Mirror with 12 I-light spots adjustable in brightness  
Satin aluminium profile

The silver painted beech uprights and the 4 wheels with brakes make the mirror extremely handy, stable and it can be positioned where necessary.

- ◆ **Uprights** in dried silver painted beech
- ◆ **Anodized** aluminium structure
- ◆ Mirror thickness 4 mm
- ◆ **12 I-light** lamps
- ◆ **Customizable** surface with company logo or name
- ◆ **Handcrafted** in Italy
- ◆ Safety film
- ◆ 110-240V compatible

### Technical Details

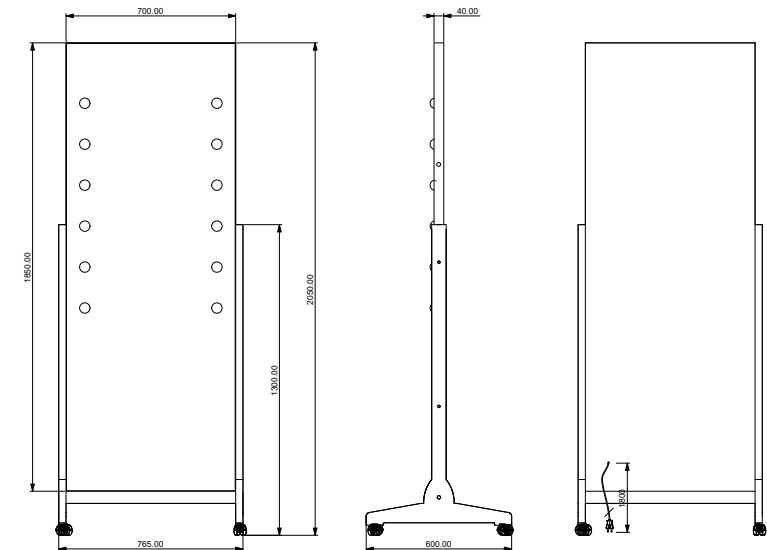

## MDE518.rolling mirror





**Professional** I-light lighting system  
with **12 dimmable I-light** lighting  
lenses

Extruded aluminium profile, 5° splay internal reverse side

Wall-mounted mirrors with diffused and adjustable lighting based on I-light technology. This exclusive technology yields a 180° light around the face and remove any shadow area.

The mirror does not need any lamp, because it encases the special I-light Opaltech lenses. The I-light technology reflects a led colour mixing at 4200° Kelvin (morning natural light hue).

We recommend this mirror for academies, beauty salons and perfumeries.

- ◆ Anodized aluminium frame with silver chrome finish or painted white/black
- ◆ Splayed 5° frame
- ◆ Lighting system with 12 I-light dimmable lenses
- ◆ **Customizable** surface with company logo or name
- ◆ **Handcrafted in Italy**
- ◆ Safety film
- ◆ 110-240V compatible

#### Dettagli Tecnici

##### SP300.CR

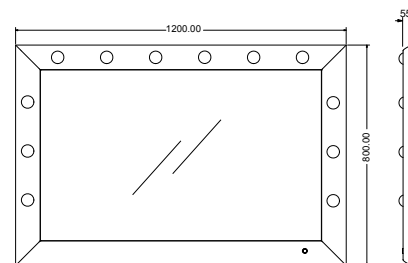

##### SP301.B

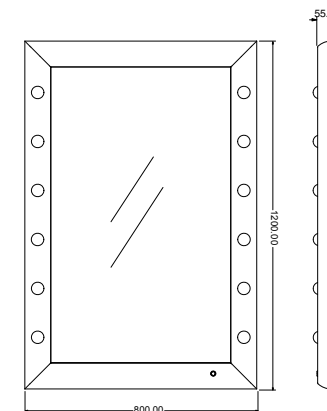

## Wall mirrors SP line



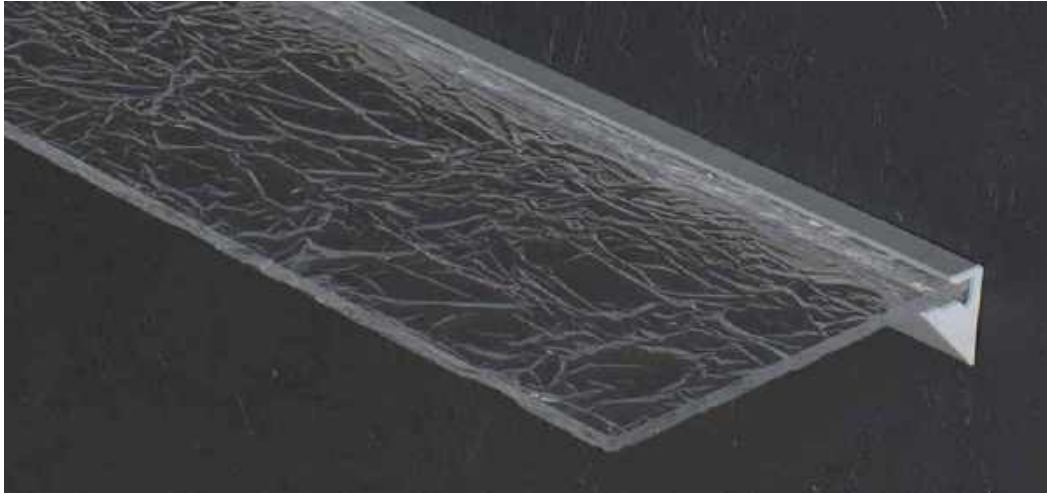

Ice effect methacrylate with anodized aluminium profile.

Methacrylate or tempered glass shelves available in 3 sizes, ice or transparent effect. Ideal complement for **MDE** mirrors.

- ◆ Anodized aluminium **profile**
- ◆ asy and safe **mounting**
- ◆ 100% made in Italy

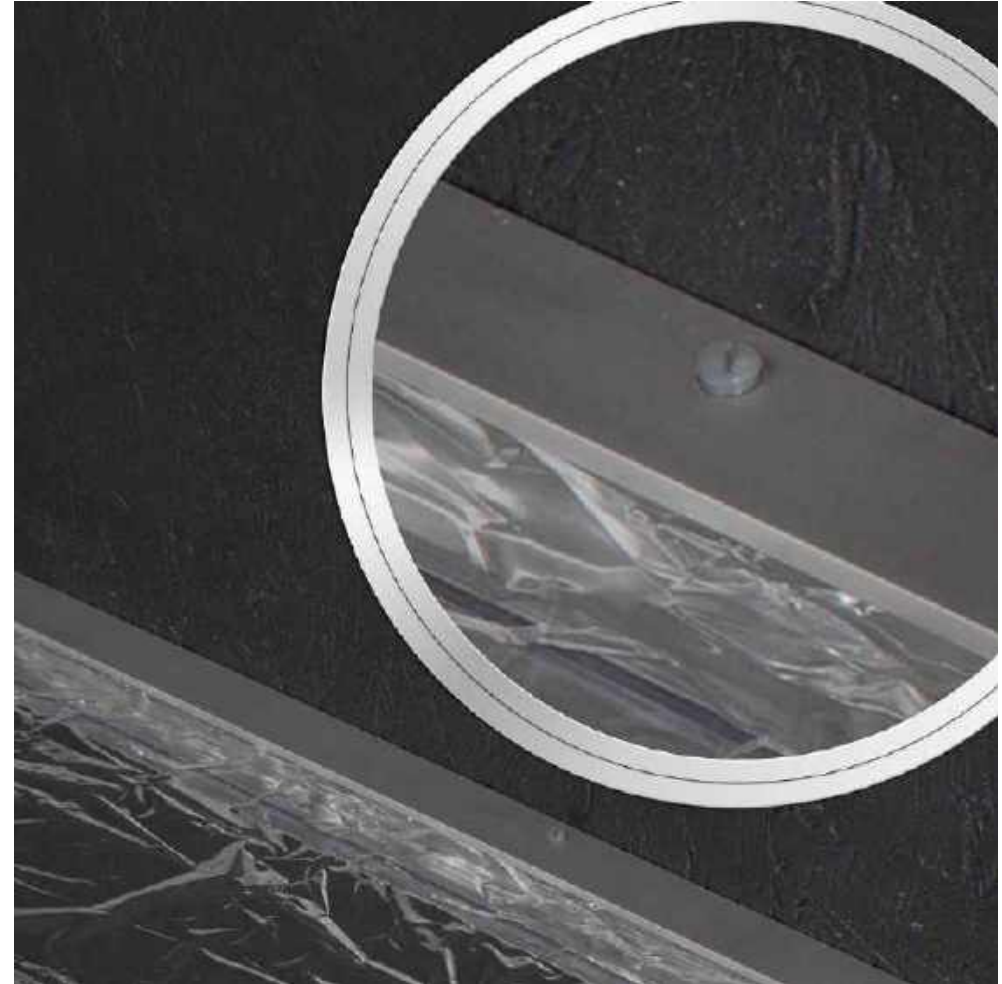

Easy and safe mounting

# Shelves line

## Technical Details

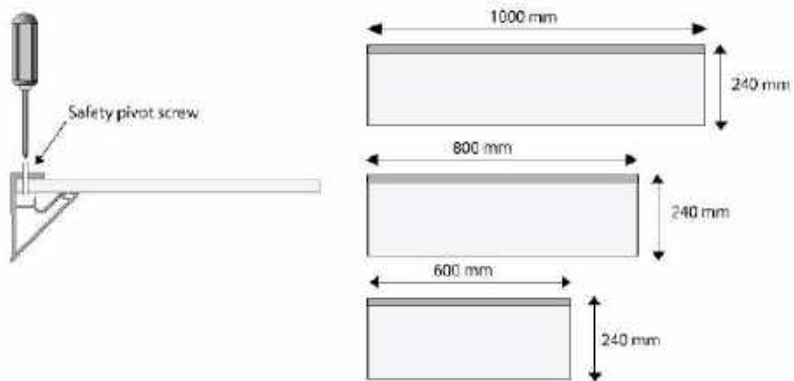

All products by Cantoni are made in Italy with carefully selected materials.  
Each product is the result of a careful study to ensure the best balance between aesthetics and technology.  
The authenticity of each piece by Cantoni is ensured by our trademark.

We are always available to respond to every request and question about products.  
Our technical department is then available for custom projects

PLEASE NOTE:

Cantoni reserves the right to modify at any time the items in the catalogue for technical or commercial purposes.  
Shipments are made from our offices in San Marino





## CANTONI TRADING SRL

### *Headquarters*

Via Guardia di Rocca 10 - 47899 Galazzano - Rep. San Marino

### *Registered Office e Showroom*

Strada degli Angariari 25 - 47891 Rovereta - Rep. San Marino

Tel. (+378) 0549 977527 - Fax (+378) 0549 876501

[sales@cantonionline.com](mailto:sales@cantonionline.com)

[www.cantonionline.com](http://www.cantonionline.com)

